



Please write clearly in block capitals.

Centre number

Candidate number

Surname _____

Forename(s) _____

Candidate signature _____

I declare this is my own work.

Functional Skills Level 1

MATHEMATICS

Paper 1 Non-Calculator

Time allowed: 30 minutes

Materials

For this paper you must have:

- mathematical instruments.
- You must **not** use a calculator.



For Examiner's Use

Question	Mark
1-5	
6	
TOTAL	

Instructions

- Use black ink or black ball-point pen. Draw diagrams in pencil.
- Answer **all** questions.
- You must answer the questions in the spaces provided. Do not write outside the box around each page or on blank pages.
- If you need extra space for your answer(s), use the lined pages at the end of this book. Write the question number against your answer(s).
- Do all rough work in this book. Cross through any work you do not want to be marked.
- State the units of your answer where appropriate.

Information

- The marks for questions are shown in brackets.
- The maximum mark for this paper is 20.
- You may ask for more answer paper, graph paper and tracing paper. These must be tagged securely to this answer book.

Advice

In all calculations, show clearly how you work out your answer.



N 0 V 2 1 8 3 6 1 1 0 1

IB/H/Nov21/E5

8361/1
QAN 603/4257/2



PASS
FUNCTIONAL
SKILLS

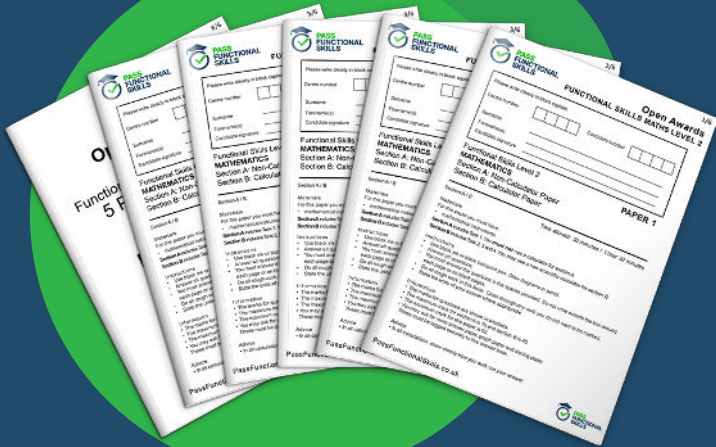

Functional Skills Maths
Level 2 Practice Papers

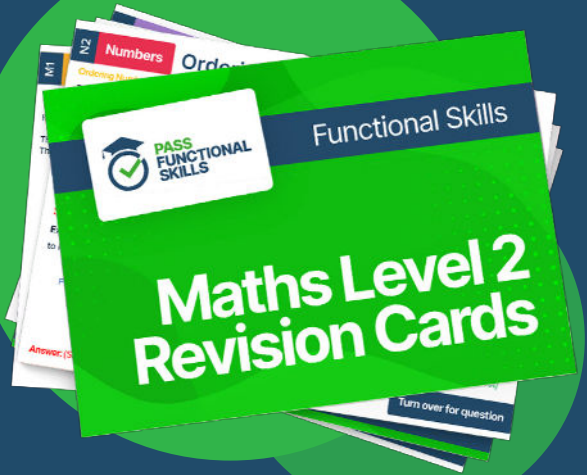

Functional Skills Maths
Level 2 Revision Cards



Functional Skills English Level 2
Practice Papers & Revision Cards



Functional Skills Maths
Level 2 Pocket Revision Guide

Or visit

passfunctionalskills.co.uk

Section A

Answer **all** questions in the spaces provided.

- 1 Circle the number that is 7 less than -10 [1 mark]

 -17 -3 3 17

- 2 Work out 12^2 [1 mark]
Circle your answer.

 14 24 104 144

- 3 Work out $36 - 5 \times 7$ [2 marks]

$$5 \times 7 = 35$$

$$36 - 35 = 1$$

Answer 1

- 4 Complete the table to show equivalent fractions, decimals and percentages.

[3 marks]

Fraction	Decimal	Percentage
$\frac{3}{4}$	0.75	75%
$\frac{7}{10}$	0.7	70%
$\frac{1}{5}$	0.2	20%

- 5 Use $5 \times 16 = 80$ to work out 50×0.16

[1 mark]

$$5 \times 16 = 80$$

$$50 \times 16 = 800 \text{ (add a 0)}$$

$$50 \times 0.16 = 8 \text{ (take away 2 0's)}$$

Answer 8

8

Turn over for Section B

Turn over ►



Section B

Answer **all** questions in the spaces provided.

6 Party planning

Hanifa is planning a party.

6 (a) Hanifa hires a hall for the party.

The hall is a rectangle and measures 12 metres by 9 metres.

Here is a list of what she wants in the hall.

DJ table	1 m by 2 m rectangle
Refreshments table	1 m by 3 m rectangle
Dance floor	5 m by 5 m square

There must be a space of at least 1 metre round each table.

On the scale diagram below, draw and label a possible plan for the hall.

[4 marks]

Scale:  represents a 1 m by 1 m square

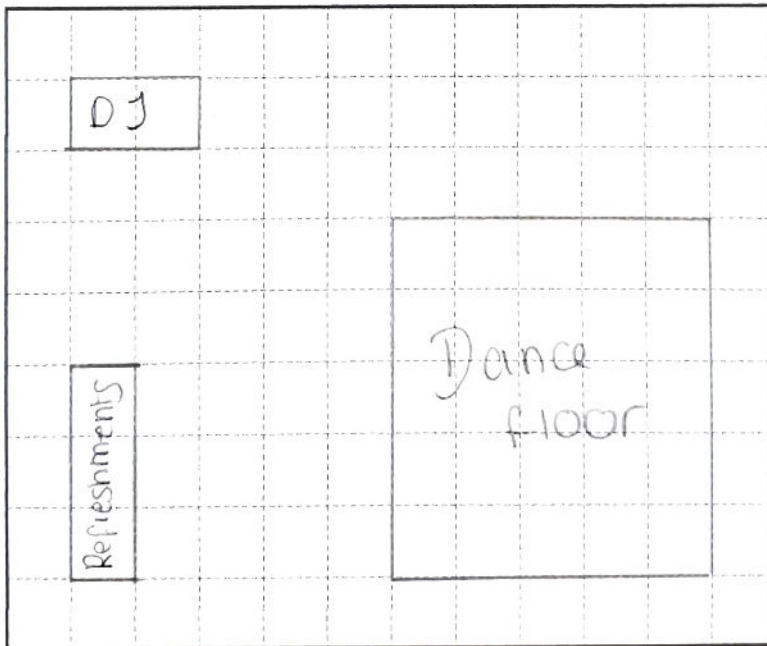

Do not write
outside the
box

- 6 (b) Here are the amounts Hanifa spends on the party.

DJ hire	£433
Food and drink	£278
Hall hire	£11.50 per hour
Dance floor hire	£10 per square metre

The hall is hired for 4 hours.

Show that altogether Hanifa spends £1007

[5 marks]

COSTS :

$$1. \text{ DJ hire} = \textcircled{\pounds 433}$$

$$2. \text{ food and drink} = \textcircled{\pounds 278}$$

$$3. \text{ Hall hire} = \pounds 11.50 \times 4 \text{ hours} \\ = \textcircled{\pounds 46}$$

$$4. \text{ Dance floor hire} = 5\text{m} \times 5\text{m} \\ = 25\text{m}^2 \\ 25 \times \pounds 10 = \textcircled{\pounds 250}$$

$$\text{Total} = \pounds 433 + \pounds 278 + \pounds 46 + \pounds 250 \\ = \pounds 1007$$

Question 6 continues on the next page

Turn over ►



- 6 (c) Hanifa put £960 in a bank account one year ago.
She gets 5% simple interest each year.

Is there enough in the account to pay the £1007?

You **must** show your working.

[3 marks]

£960

find 5% of £960

$$10\% \text{ of } £960 = £96$$

$$5\% \text{ of } £960 = £96 \div 2 = £48$$

$$\text{money now} = £960 + £48 = £1008$$

This is enough money (she has £1008 and needs £1007).

12

END OF QUESTIONS





FUNCTIONAL SKILLS ONLINE COURSES

- ✓ Your answers are analysed to determine your Current Level
- ✓ Suggested courses for you to enrol on based on your calculated level
- ✓ Always know the level you are currently working at
- ✓ Determine when you are ready to sit your exam

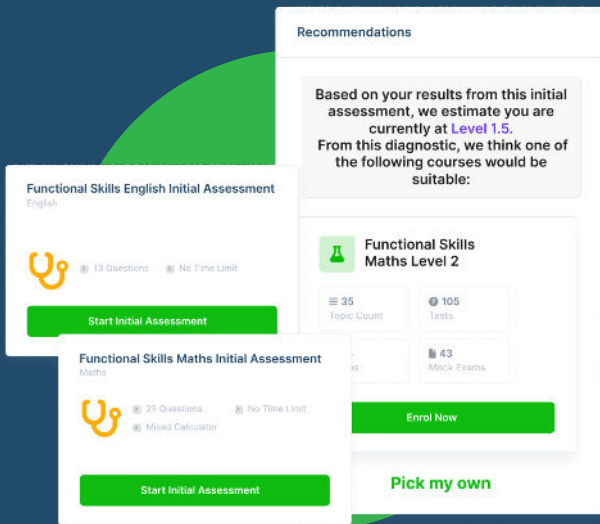

- ✓ Explainer videos on every topic
- ✓ Quick-fire style multiple choice questions
- ✓ Test your knowledge with exam-style questions
- ✓ Written solutions for all questions

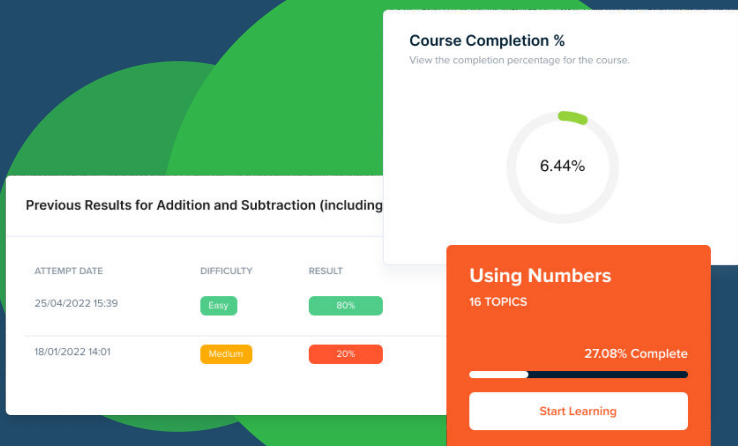
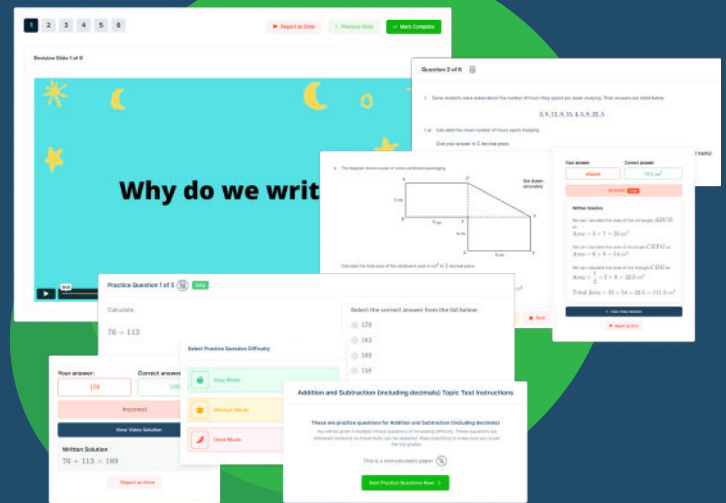

- ✓ See your progress through as you progress through each topic area
- ✓ Get your average scores for practice questions, topic tests and mock exams
- ✓ View all practice question, topic test and mock exam attempts over time
- ✓ View historical attempts to analyse your progress over time

Or visit
passfunctionalskills.co.uk